

BENEFITS

- Sizeable holes. Facilitate the cutting and distance calculation.
- Small hole. Limited waste of material.
- Clamps fixing with EP.
- National production. Guaranteed quality.
- Installation using M12 threaded rod or lower.
- Huge accessories range.



INSTALLATION PARAMETERS

Analyze the recommended load of the channel to decide the maximum space between the supports and the maximum channel length.

MAIN DIMENSIONS [mm]

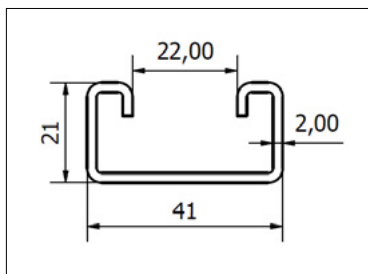

Reference	Area [mm ²]	h [mm]	b [mm]	Thickness [mm]	Weight [kg/ml]	Inertia [mm ⁴]		Resistant torque [mm ³]	
						I _x	I _y	W _x	W _y
41 x 21 x 2	173,274	21,00	41,00	2,00	1,36	10023	47153	991	2300

INSTALLATION PROCEDURE

Electric installation



Plumbing installation

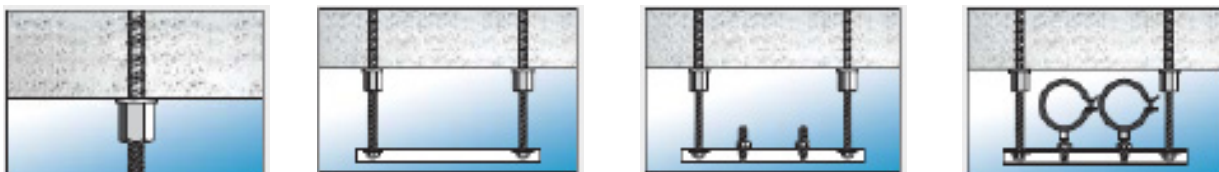

● ● ● Small Things Matter ●

RECOMMENDED LOADS ²

Load on the center. For other load distribution, consider all the loads as a unique load in the center of the channel.

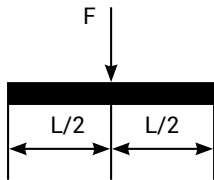

Load [kg]	Maximum length [mm]
231	250
192	300
165	350
144	400
128	450
115	500
96	600
82	700
72	800
64	900
58	1000
51	1100
43	1200
36	1300
31	1400
27	1500
20	1750
15	2000
12	2250
10	2500
8	2750
7	3000

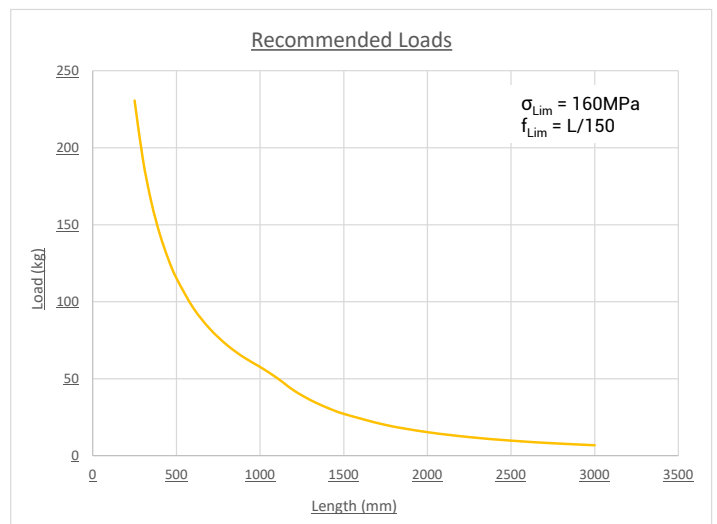

Values in Newtons [N].

⁽²⁾ Values for a maximum channel deformation $L/150$ and $\sigma_{allow} 160N/mm^2$.

APPLICATIONS

- Cable tray (perforated and wire) installation.
- M8 and M6 clamp installation.
- Air conducts installation.
- Machinery supporting.

